

60 minute fire rated 30 Rw single leaf acoustic / smoke / fire door

DESCRIPTION

Pyropanel AS-30-PAN-E is a 30 Rw, 1 hour fire rated 48mm single leaf acoustic door that utilises a Pyropanel Euroseal concealed perimeter seal and an approved bottom seal.

APPLICATIONS

Ideal for unit entry applications or anywhere that requires 60 minutes of fire resistance and an acoustic rating of 30 Rw.

FEATURES

Acoustic Rating

- 30 Rw (30 STC)

Fire Resistance

- FRL -/60/30

Door Configuration

- Single leaf hung in a steel or timber frame.

Perimeter Seals

- Pyropanel Euroseal® concealed smoke/acoustic seal

Bottom Seals

- See seal combinations listed on page 2.

Thickness

- 48mm (Nominal)

Size

- Maximum Size - 2420 x 1020 or 2200 x 1120 (-/60/30)

Hinges

- Minimum 3 steel hinges

Frame

- Pyropanel KDHW timber or packed steel frame

Finish

- MDF as standard

OPTIONAL EXTRAS

- Pre-hung in steel or timber frame
- Ply, Veneer, Steel or Laminate facings
- Vision panels—300 x 200 or 600 x 100mm.
- Kick Panels of 1mm Stainless Steel to selected height.

INSTALLATION

Door frame must be tightly sealed against wall structure using Pyropanel Multiflex fire and acoustic sealant. Metal door frames will require packing with Pyropanel FR board, Fire rated plaster, concrete or mortar to achieve desired acoustic rating.

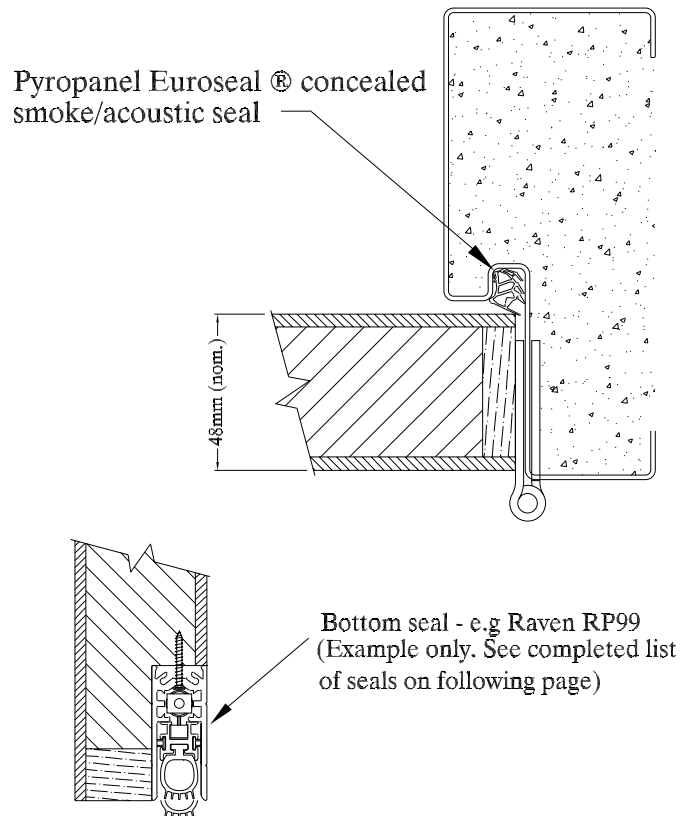

HOW TO SPECIFY

"Door to be a Pyropanel AS-30-PAN-E acoustic door with -/60/30 FRL, installed into a Pyropanel Fire rated timber / packed metal* door frame, with Pyropanel Euroseal and Raven RP99si* seals"*

* denotes example - delete, change or specify as required

60 minute fire rated 30 Rw single leaf acoustic / smoke / fire door
SEAL COMBINATIONS

Door Type	Perimeter Seals	Bottom Seals
AS-30-PAN-E	Pyropanel Euroseal	Raven RP99si
		Raven RP38si
		Raven RP35si
		Raven RP8si
		Lorient LAS8001si
		Lorient LAS8002si
		Lorient LAS8003si
		Lorient LAS8005si
		Lorient LAS8006si
		Lorient LAS8007si
		Lorient LAS8008si
		Lorient LAS8009si
		Kilargo IS8005si
		Kilargo IS8010si
		Kilargo IS8011si
		Kilargo IS8020si
		Kilargo IS8035si
		Kilargo IS8036si
		Kilargo IS8090si
		Kilargo IS8091si
Kilargo IS8520si		
Kilargo IS8530si		

Pyropanel Developments Pty Ltd

Unit 1, 97 Lewis Rd, Wantirna South, Vic 3152

 Ph: **(03) 9837 8500** Fax: (03) 9837 8550

 Email: sales@pyropanel.com.au

 Web: www.pyropanel.com.au

Distributed by:
Australian Commercial Doors

 P: **(03) 9720 5766**

 F: **(03) 9720 5388**

 E: sales@acdoors.com.au

Pyropanel Developments has a policy of continuous improvement and reserves the right to change methods and specifications without notice.

 Note: *The Tech Sheet is an uncontrolled document, If printed please refer to the Tech-Sheet on the website to check if this document is valid.*