

ACOUSTIC DOOR

AS-PYROL-A

TECH SHEET: AS-PYROL-A

Issue: 02-02-2012

Non fire rated 36 & 34 Rw single acoustic / smoke door

DESCRIPTION

Pyropanel AS-PYROL-A is a non fire rated 48mm single leaf acoustic. This door comes standard with LP-design metal facings and door edges.

APPLICATIONS

Ideal for applications that require no fire resistance, but require smoke resistance and an acoustic rating of 34 or 36 Rw, such as acoustic smoke doors in hospitals, schools and offices.

FEATURES

Acoustic Rating

- 36 Rw or 34 Rw

Test Certificate number

- TL409(m)

Door Weight

- Approx 40kg/m²

Smoke Resistance

- Meets BCA requirement for a smoke door

Door Configuration

- Single leaf hung in a timber or steel frame

Thickness

- 48mm (Nominal)

Size

- Maximum Size - 2500 x 1000 or 2100 x 1200

Hinges

- Minimum 3 steel hinges

Frame

- Packed pressed metal frame

Finish

- Metal facings (LP design)

OPTIONAL EXTRAS

- Pre-hung in steel frame
- Stainless steel face and edge
- Vision panels - 300 x 200 or 600 x 100mm.

INSTALLATION

Door frame must be tightly sealed against wall structure using Pyropanel Multiflex or an approved alternative acoustic sealant. Metal door frames will require packing with Pyropanel FR board, plasterboard, concrete or mortar to achieve desired acoustic rating.

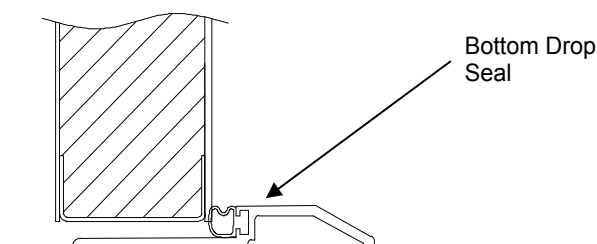
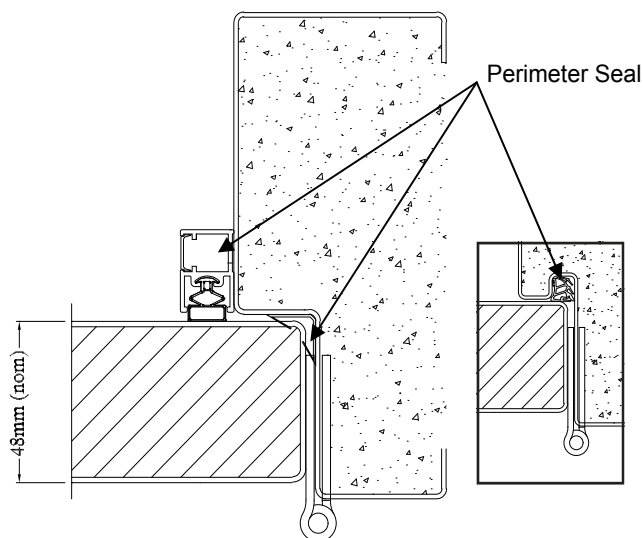

Door Type	Perimeter	Bottom	Rw
AS-PYROL-A1	IS6030 + LE1515	Pyrosill	36
AS-PYROL-A2	Zero 3708A	Pyrosill	36
AS-PYROL-A3	Euroseal	Pyrosill	34

HOW TO SPECIFY

"Door to be a Pyropanel AS-PYROL-A1 acoustic door installed into a timber* or packed metal door frame**"*

* denotes example—delete, change or specify as required



Pyropanel Developments Pty Ltd
 122-124 Beresford Rd, Lilydale, VIC, 3140
 Ph: (03) 9739 3100 Fax: (03) 9739 3115
 Email: sales@pyropanel.com.au
 Web: www.pyropanel.com.au

Distributed by:



Australian Commercial Doors Pty Ltd
 P: 03 9720 5766
 F: 03 9720 5388
 sales@acdoors.com.au