

BULLET RESISTANT DOORS

Special Purpose Bullet Resistant Doorsets

DESCRIPTION

Pyropanel Bullet Resistant doorsets are tested to Australian Standards, to suit all applications. They have a nominal thickness of 50mm, and are supplied with a heavy duty steel door frame, factory-fitted ball bearing 100mm x 100mm butt hinges, or continuous piano hinges. All locksets and other door hardware are required to be factory-fitted to ensure no loss of integrity and to ensure correct positioning of steel plates within the door.

APPLICATIONS

Pyropanel Bullet Resistant doorsets are suitable for a wide range of applications such as banks, embassies, prisons, cash rooms, apartment entry doors, etc.

FEATURES

- Tested to AS/NZS 2343: 1997 achieving classifications of G0, G1, G2, R2, S0, and S1, as well as the AK47 urban assault rifle.
- Constructed with fire resistant materials (but not fire tested to AS 1530.4).

OPTIONAL EXTRAS

- Smoke and acoustic seals.
- Bullet resistant vision panels.

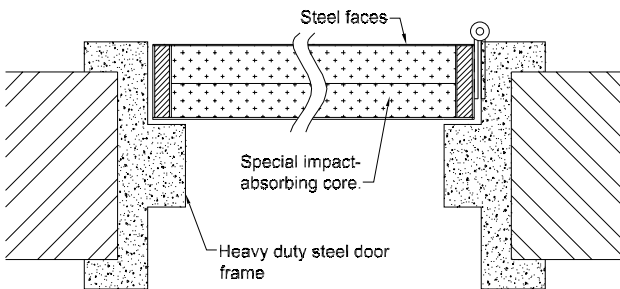

Illustration of typical doorset with frame solidly grouted into masonry wall. Special bullet resistant frames can be designed for stud wall applications.

CLASSIFICATION TABLE (AS/NZS 2343:1997)

| CLASS | WEAPON TYPE | CALIBRE | AMMUNITION | VELOCITY (m/s) |
|-------|---------------------|---------------------|------------------------|----------------|
| G0 | Hand Gun | 9mm | 7.4g standard bullet | 405 +/- 15 |
| G1 | Hand Gun | .357 Magnum | 10.2g flat nose bullet | 450 +/- 15 |
| G2 | Hand Gun | .44 Magnum | 15.6g flat nose bullet | 480 +/- 15 |
| R2 | Rifle | 7.62mm | 9.3g bullet | 850 +/- 15 |
| S0 | Shotgun | 12 gauge full choke | 32g 70mm no.6 SG shot | 400 +/- 15 |
| S1 | Shotgun | 12 gauge full choke | 24.8g 70mm single slug | 450 +/- 15 |
| AK-47 | Urban Assault Rifle | 7.62mm | 8.3g jacketed bullet | 715 +/- 15 |

MODELS AVAILABLE

| MODEL | BULLET RESISTANCE |
|-------|--------------------------------|
| BR-C | G0, G1, G2, R2, S0, S1 & AK-47 |

HOW TO SPECIFY

"Door to be a Pyropanel BR-C Bullet resistant doorset, 50mm thick, installed in a Pyropanel heavy duty frame solidly packed with concrete".